

STANDARD F 2400

Fluorescent Immunoassay Analyzer

STANDARD F 2400 is a fluorescent immunoassay systems and have been designed for easy and reliable measuring of diverse tests. STANDARD F 2400 provide LIS connectivity to connect the majority of existing information system in hospitals. So it is good to use in hospital, clinic or small to medium size lab use.

All the parameters are randomly accessible to the STANDARD F Analyzer without any pre-procedure. The analyzer recognizes each parameter once the test device is inserted, and display graphical test procedure for the sample preparation.



SPECIFICATIONS	F 2400
Test Method	Fluorescent Immunoassay (FIA)
Analysis	Quantitative/Qualitative Test
Test Capacity	70 Tests per Hour
Number of Memories	5,000 (Run Test)
Test Mode	Standard Test
Power	AC/DC Adapter
Display	10.1" Color TFT LCD (1024 X 600)
Display Control	Graphic User interface
Printer	Built-in
Connectivity	HL7 v2.6(PCD-01) / POCT1-A
Real Time Clock	Including RTC Back up Battery
Auto-ID	2D Barcode
Dimensions	510 x 566 x 297 mm
Weight	20.0 kg



EXCELLENT SENSITIVITY & SPECIFICITY WITH FLOURESCENT IMMUNOASSAY

- Proven lateral flow design enhanced with fluorescent immunoassay technology featuring Europium
- Specific antibodies selected to optimize performance in concert with fluorescence

OBJECTIVE TEST RESULTS

- Eliminate ambiguous test results as the analyzer interprets and determines the results

CUT OF INDEX (COI)

- Great reference value for medical decision-making

RAPID TEST RESULTS

- Provides accurate, objective and automated results

2D BARCODE TECHNOLOGY

- Auto coding procedure by recognizing 2D barcode
- Reduce time and errors associated with manually recording LOT specific information

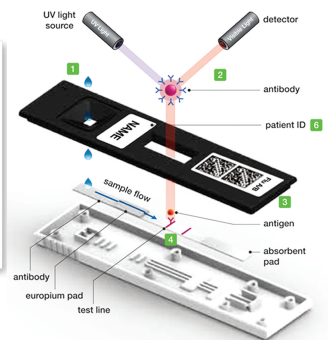
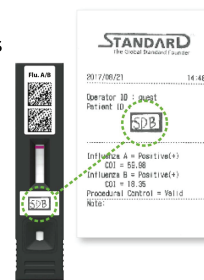

Overview of STANDARD F 2400 Analyzer

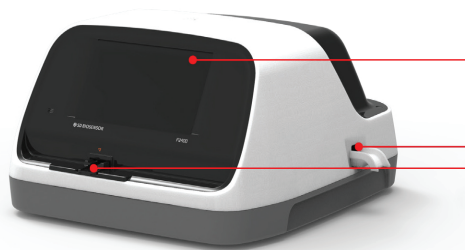

Color TFT LCD

Inlet for Insertion of Test Device
Test device outlet

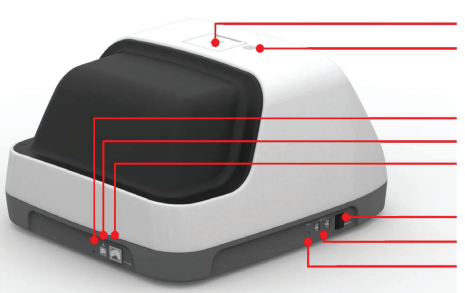

Printer Cover
Printer Cover Open Button

Mini USB
LAN
AC Power Connection

Power Switch
USB x 4
Additional Device Connection Part



Calibration Set



Control Bead



Control Swab

Reliable result

Provides Calibration set and Control reagent having more confidence in the result.

Accurate Result

Take an accurate collection with fixed volume dropper

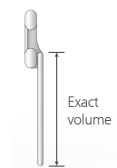

STANDARD F Analyzers are qualitative and quantitative fluorescent immunoassay systems and have been designed for easy and reliable measuring of diverse parameters. Rapid, highly accurate and reliable results help you to reduce uncertainty of treatment and make better the quality of patients care.

SD BIOSENSOR Ordering Information

STANDARD F

» Analyzer

Product	Pack size	Dimension (W/L/H)	Weight	Cat. no.
F2400	Unit	510 x 566 x 297mm	20.0Kg	10FA24
F200	Unit	200 x 240 x 205mm	2.5Kg	10FA20
d-BLOCK Incubator	Unit	220 x 184 x 73mm	1.9 kg	12INC10

» Parameters

Category	Product	Specimen	Specimen volume	Testing time	Pack size	Cat. no.
Qualitative assays						
Respiratory Disease	COVID-19 Ag FIA	NP**swab	-	15 mins	25T	10COV30D
		Nasal swab	-		25T	10COV31D
	COVID-19 IgM/IgG Combo FIA	WB/S/P*	10-20 µl	15 mins	25T	10COV50G
	SARS-CoV-2 Variant nAb FIA	S/P*	100 µl	35 mins	20T	10COV120B
	SARS-CoV-2 Total nAb FIA	S/P*	100 µl	35 mins	20T	10COV120B
	COVID/Flu Ag Combo FIA	NP**swab	-	15 mins	25T	10COV71D
		Nasal swab	-		25T	10COV70D
	Influenza A/B FIA	NP** swab /wash /aspirate	-	1.5-10 mins	25T	10INF20D
	RSV Ag FIA	NP** swab /wash /aspirate	-	5-15 mins	25T	10RSV10D
	Strep A Ag FIA	Throat swab	-	5 mins	25T	10STR10D
	LegionellaAg FIA	Urine	100 µl	5-15 mins	25T	10LEG10D
	S. pneumoniaeAg FIA	Urine, CSF	100 µl	5-10 mins	25T	10SPN10D
	Adeno Respi Ag FIA	NP**swab, Nasal swab	-	15 mins	25T	10ADE10D
	TB-Feron FIA (IFN-gamma)	Plasma	100 µl	15 mins	30 Devices	10TBF10E
Dengue NS1 Ag FIA	WB/S/P*	100 µl	5-15 mins	25T	10DEN10D	
Dengue IgM/IgG FIA	WB/S/P*	10 µl	15 mins	25T	10DEN20D	
Vector Borne Disease	Zika Ag FIA	WB/S/P*	100 µl	5-15 mins	25T	10ZK10D
	Zika IgM FIA	WB/S/P*	10 µl	15 mins	25T	10ZK30D
	Chikungunya IgM/IgG FIA	WB/S/P*	10 µl	15 mins	25T	10CHI10D
	Tsutsugamushi IgM/IgG FIA	WB/S/P*	10 µl	15 mins	25T	10TSU10D
	Lyme IgM/IgG FIA	WB/S/P*	10 µl	15 mins	25T	10LYM10D
	Gastrointestinal Disease	Norovirus Ag Plus FIA	Feces	50-75 mg	15 mins	25T
Rotavirus Ag		Feces	40-70 mg	15 mins	25T	09ROT10D
Rota/Adeno Ag FIA		Feces	50-75 mg	20 mins	25T	10ROT10D
Rota/Adeno Ag		Feces	40-70 mg	20 mins	25T	09ROT20D
H. pyloriAg FIA		Feces	40-70 mg	10 mins	25T	10HPY10D
C. difficile GDH FIA		Feces	40-70 mg	15 mins	25T	10CDG10D
C. difficile Toxin A/B FIA		Feces	40-70 mg	15 mins	25T	10CDT10D
Hepatitis	Anti-HBs FIA	WB/S/P*	100 µl	15 mins	25T	10AHB10D
	HBsAg FIA	WB/S/P*	100 µl	20 mins	25T	10HBS10D
	HCV Ab FIA	WB/S/P*	10 µl	15 mins	25T	10HCV10D
	HAV IgM FIA	WB/S/P*	10 µl	15 mins	10T	10HAV10A
Blood Borne Disease	HIV Ag/Ab FIA	WB/S/P*	100 µl	15 mins	25T	10HIV20D
STI	Syphilis Ab FIA	WB/S/P*	WB: 20 µl, S/P: 10 µl	15 mins	25T	10SYP10D
Quantitative assays						
Chronic Disease	HbA1c	Whole blood	5 µl	3 mins	20T	10A1C10B
	U-Albumin FIA	Urine	3 µl	5 mins	20T	10UAL10B
Inflammation	PCT FIA (Serum)	Serum	50 µl	15 mins	20T	10PCT10B
	PCT FIA	WB/S/P*	100 µl	15 mins	20T	10PCT20B
	CRP	WB/S/P*	5 µl	3 mins	20T	10CRP10B
Cardiovascular Disease	TnI Pro FIA	WB/S*	100 µl	10 mins	20T	10HST20B
	TnI/CK-MB Combo FIA	WB/S*	100 µl	10 mins	20T	10TNI20B
	TnI FIA	WB/S*	100 µl	10 mins	20T	10TNI10B
	CK-MB FIA	WB/S*	100 µl	10 mins	20T	10CKM10B
	D-dimer FIA	WB/P*	10 µl	7 mins	20T	10DDI10B
	hs-CRP	WB/S/P*	5 µl	3 mins	20T	10HSC10B
	NT-proBNP FIA	WB/S*	100 µl	15 mins	20T	10NTP10B
Hormone	Vitamin D FIA	S/P*	35 µl	45 mins	20T	10VIT10B
	β-hCG FIA	WB/S*	50 µl	15 mins	20T	10BHC10B
	LH FIA	WB/S/P*	20 µl	15 mins	20T	10LH10B
Thyroid function	TSH-II FIA	WB/S*	35 µl	15 mins	20T	10TSH20B
	TSH FIA	Serum	100 µl	15 mins	20T	10TSH10B
	fT4	Serum	50 µl	15 mins	20T	10FT410B
	T4	Serum	50 µl	15 mins	20T	10T410B
	T3	Serum	100ul	25 mins	20T	10T310B
Tumor Marker	PSA FIA	WB/S/P*	WB: 20 µl, S/P: 100 µl	10 mins	20T	10PSA10B
	iFOB FIA	Feces	3 drops	5 mins	50T	10IFO10C

*WB : Whole Blood / S : Serum / P : Plasma, **NP : Nasopharyngeal